

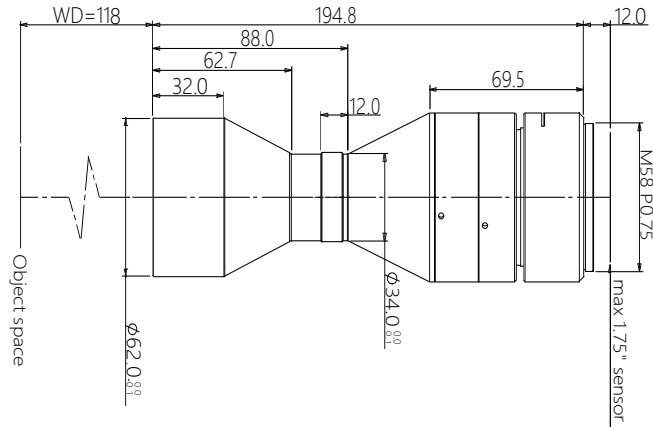

vision solution

Specification

SBS-SCJ118-0.69 High Resolution Double Telecentric Lens



Features (SBS-SCJ series)

- * Excellent double telecentric design for high resolution image result.
- * Field of view is from 26mm to 300mm, suitable for most of application.
- * Big Iris, low distortion, high parallel degree, big depth of view.
- * Sensor size is available for 1/2.5" 1/2" 1/1.8" 2/3" 1" 4/3" 1.75" 2" $\phi 39$ 35mm full.

Parameters

FOV (Dia.mm)	42
Mag.(x)	0.690
WD (mm)	118 \pm 3
Sensor size (Dia.mm)	29(1.75")
Image F#	11.4
Image MTF30(pl/mm)	>70
Object DOF (mm)	\pm 1.6@F20
Object distortion (%)	<0.1
Object telecentric degree	<0.1
Object I/O(mm)	325 \pm 3

Mechanical

Mount	M42/M48/M58
Total length (mm)	194.8
N.W(KG)	0.9

Field of View (mm x mm)

1.75" CMV12000 (22.53x16.90)	32.7x24.5
1.75" PYTHON16k (18.43x18.43)	26.7x26.7
1.75" LineScan-4k (28.8mm)	41.7